

Folwark - nový I.(1:700), 1/1



Folwark - nový II(1:600), 1/1



This is a detailed cadastral map of a residential area in Trinec. The map shows a large, irregularly shaped plot of land divided into numerous smaller, numbered plots. The plots are color-coded: green for green spaces, yellow for building footprints, and white for other areas. The map includes surrounding streets and property boundaries. The word "Trinec" is visible in the bottom left corner. The map is oriented with North at the top.

Třinec

Guty(1:300), 1/1



Karpentná(1:400), 1/1



Kojkovice(1:300), 1/1

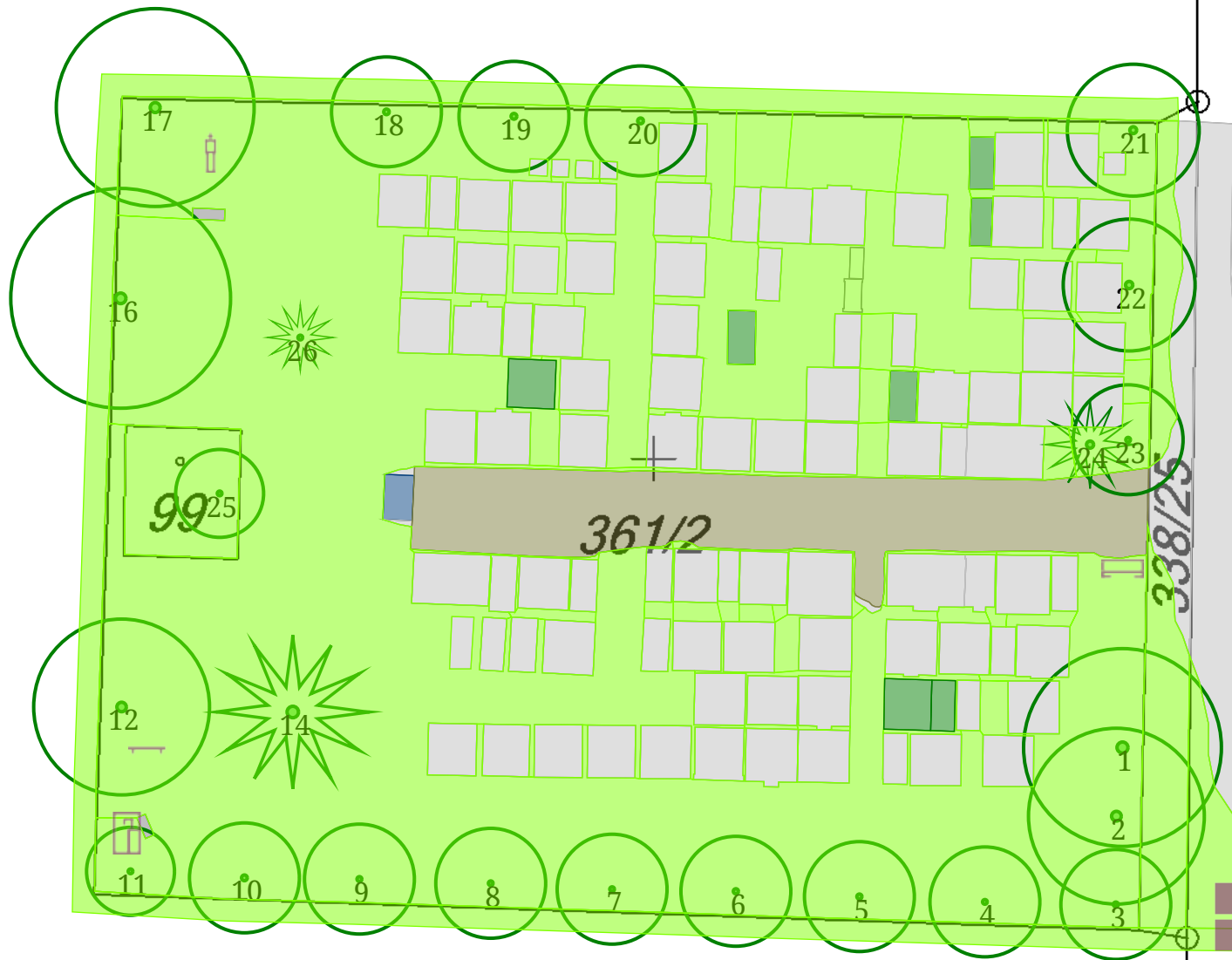

Nebory(1:600), 1/1



Oldřichovice(1:600), 1/1



Podlesí(1:600), 1/1



Tyra(1:400), 1/1

